

DWG. NO.

REVISIONS			
REV	DESCRIPTION	APPROVED	DATE

"A" IN PART INDICATES LENGTH OF SUBSTRATE IN MILS
(ie ATP 010-050-100 IS A 100 MIL LONG SUBSTRATE)

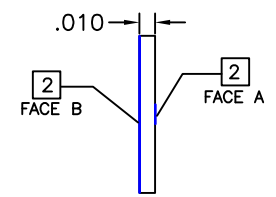
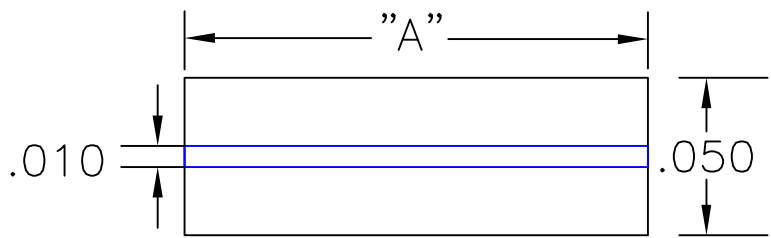
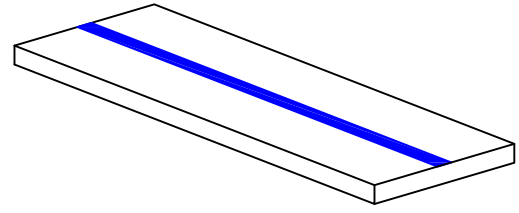

NOTES: (UNLESS OTHERWISE SPECIFIED)

- MATERIAL: .010 THK ALUMINA 99.6%
(X) ASFIRED SURFACE FINISH <4 MICROINCHES
- METALIZATION A & B SIDE
T.W.= 400-800 A*
Au= 120 u min.

THIS DOCUMENT CONTAINS CONFIDENTIAL PROPRIETARY INFORMATION THAT IS ADVANCED LOGGING COMPONENTS (ALC) PROPERTY. DO NOT DISCLOSE TO OR DUPLICATE FOR OTHER EXCEPT AS AUTHORIZED BY ALC.

ITEM	QTY	PART/MATERIAL - DESCRIPTION	MAT'L-DWG NO.	MAT'L-SPEC
PARTS LIST				
UNLESS OTHERWISE SPECIFIED DIMENSIONS ARE IN INCHES TOLERANCES ARE: FRACTIONS .01 ± .005 DECIMALS .005 ± .001 ANGLES ± 1°				
C/O GENERATED DRAWING DO NOT MANUALLY EDIT				
APPROVALS		DATE		
DRAWN C. QUESADA		11/18/03		
MECH		TITLE		
ELEC		SUBSTRATE		
NONE		50 OHM LINE		
NONE		SIZE		
NONE		PAGE CODE		
NONE		DWG. NO.		
NONE		ATP-F-010-050-XXX		
NONE		SCALE		
NONE		RELEASE DATE		
NONE		SHEET 1 OF 1		



3439 EDISON WAY
FREMONT, CALIFORNIA 94538